



VITA PUMPS

VITAFLOW INC.

Tel:+86-20-38012272

Fax:+86-20-38012301

Email:sales@vita-flow.com

sales@hytco.com

Website:www.vita-flow.com

www.vitapumps.com

subject to amendments

VITA PUMPS



CM,CMF,CMH

50Hz Horizontal multistage centrifugal pump



Vita Pumps, is a professional manufacturer which develops, manufactures and sells stainless steel multistage centrifugal pumps. The flow range up to 28m³/h, the head range up to 65m. Vita water pumps has professional designs and advanced techniques. Our products are being sold to more than 60 countries and regions around the world, such as: Southeast Asia, the Middle East, Europe, USA, and Latin America.

We supply CM,CMF,CMH series light vertical multistage centrifugal pumps. The pumps are used in industrial water treatment, RO units, municipal water supply, farm irrigation, domestic water and fire water supply of high buildings, water purification, pharmaceutical industry, boiler, air-conditioning system, etc. Some of our pumps' advantages include: accurate performance, high quality standards, reasonable price, delivery on time.

The Vita brand is based on honesty and professionalism. Our working principle is: "Aim for perfect". In 2003, the factory passed the evaluation of ISO9001:2000 certification. In 2006, the factory passed the evaluation of ISO14000 environmental system certification. In 2007, the factory passed the evaluation of ISO100122003 measuring system certification. Our products have CE, TUV, ROHs, and UL certificates.

We warmly welcome you to visit our company, and would gladly to reply your enquiries, looking to find agents and business partners all over the world.



CONTENTS

General Data

General Data	03
Applications	03
Applicable medium	03
Operation condition	03
Electric Motor	03
Pump	03
Connotation of the type	04
Code number explanation	04
Technical Data	04
Material CMF	05
Material CM,CMH	06

Technical Data

CMF2 50Hz	07
CMF4 50Hz	08
CMF8 50Hz	09
CMF12 50Hz	10
CMF16 50Hz	11
CMF20 50Hz	12
CM2 50Hz	13
CM4 50Hz	14
CM8 50Hz	15
CM12 50Hz	16
CM16 50Hz	17
CM20 50Hz	18
CMH2 50Hz	19
CMH4 50Hz	20
CMH8 50Hz	21
CMH12 50Hz	22
CMH16 50Hz	23
CMH 20 50Hz	24



General Data

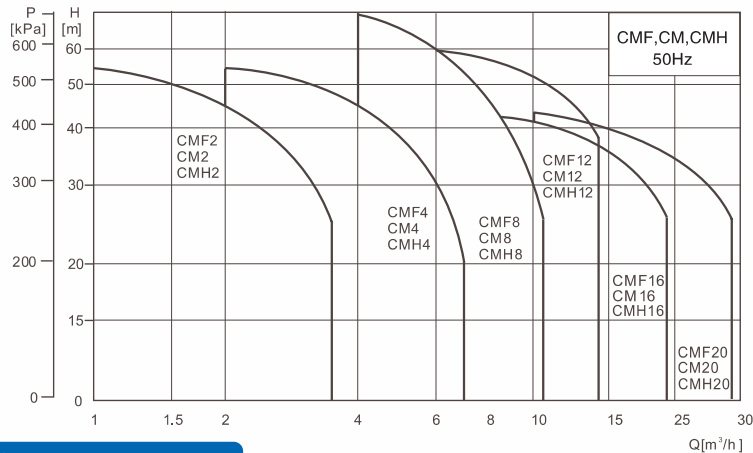

Applications

The CMF, CM(H) series are primarily for the industry :

01. Water treatment processes
02. Industrial cleaner and dishwasher
03. Water boosting on process
04. Heating and cooling for industrial process
05. Air-conditioning system
06. Air freshening heater device(soft water)
07. Water supply and boosting(drinking water light chlorine water)
08. Fertilization/metering system
09. Many other special using

Applicable medium

01. Thin, clean, non-flammable and non-explosive liquid containing no solid granules and fibers;
02. Mineral water, soft water, pure water, edible vegetable oil and other light chemical mediums.
03. When the density or viscosity of to be conveyed liquid is larger than that of water, it is necessary to select a driving motor of high power.
04. Whether a specific liquid is suitable for the pump depends on many factors, among which the most important ones are chlorine content, PH value, temperature, solvent and oil content.

Operation condition

01. Liquid temperature: ambient temperature 15°C – +70°C, hot water less than 105°C;
02. Max. environmental temperature: + 50°C
03. Max. operating pressure: 10 bar
04. Max. suction pressure is licited by mad. operating pressure

Electric Motor

01. 2-pole induction motor;
02. Single-phase: 220-240V/50Hz, 110V/60Hz, 220V/60Hz
03. Three-phase: 380-415V/50Hz, 380-415V/60Hz
04. Insulation class: B or F
05. Protection: IPX5
03. Continuous duty
04. Single-phase with input thermal protector

Pump

01. Horizontal multistage non self priming centrifugal pump, attached with long shaft electric motor.
02. Compact structure renders small size of pump; axial inlet and radial outlet.

Connection port	CMF2,CM2 CMH 2	CMF4,CM 4 CMH4	CMF8,CM8	CMH 8	CMF12,CM12 CMH12	CMF16,CM16	CMF20,CM20
Inlet	G1	G1½	G1½	G1½	G1½	G2	G2
Outlet	G1	G1	G1½	G1¼	G1½	G2	G2

Connotation of the type

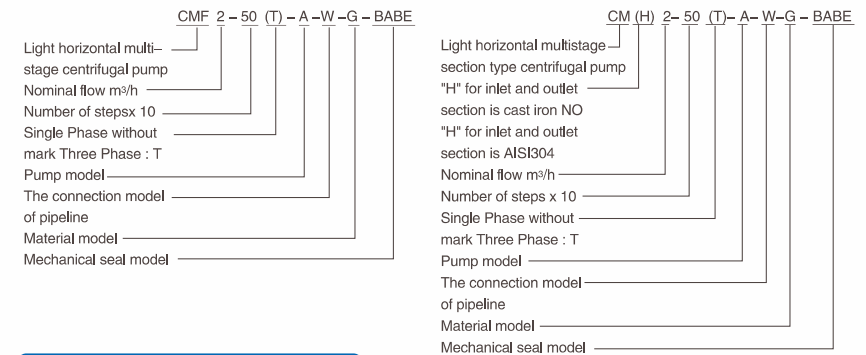

Code number explanation

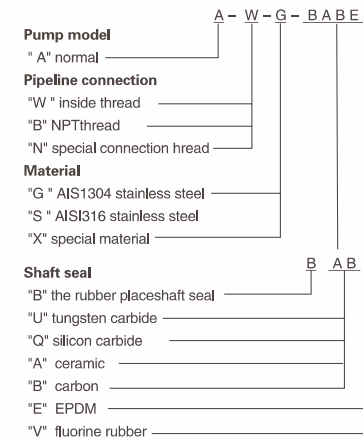

Technical Data

Performance curve resource:

- Performance curve are based on the following
01. Performance bascd on actual speed of standard motor.
 02. Carring on test by 20°C water without air.
 03. Curve are suitable for delivering liquid $\nu = 1\text{mm}^2/\text{s}$, $\rho = 1\text{g}/\text{cm}^3$.
 04. The operation of pump shall refer to the performance region described by the thickened curve to prevent overheating due to too small flow rate or overload of motor due to too large flow rate



reserves the rights to modify design and technical specifications

Material CMF

No.	Name	material	AISI/ASTM
1	Pump casing	Stainless steel	AISI304 or AISI316
2	Connection pipe	Stainless steel	AISI304 or AISI316
3	Clamp plate	Stainless steel	AISI304 or AISI316
4	Primaryguide vane	Stainless steel	AISI304 or AISI316
5	Impeller	Stainless steel	AISI304 or AISI316
6	Support guide vane	Stainless steel	AISI304 or AISI316
7	Middle section section	Stainless steel	AISI304 or AISI316
8	Shaft	Stainless steel	AISI304 or AISI316
9	Outlet section	Stainless steel	AISI304 or AISI316
10	Mechanical seal	BABE, BABV, BQQE, BQQV	
11	Base frame	Cast iron	
12	Front cover	Aluminum alloy	
13	Quick clampholder	Stainless steel	AISI304 or AISI316
14	Plug	Stainless steel	AISI304 or AISI316

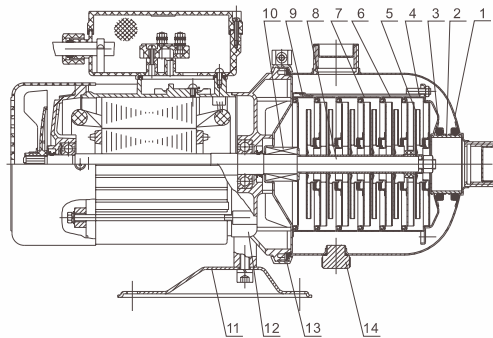

Material CM,CMH

No.	Name	material	AISI/ASTM
2	Bearing sleeve	Hard alloy	
3	Support guide vane	Stainless steel	AISI304 or AISI316
4	Separating sleeve	Stainless steel	AISI304 or AISI316
5	Middle section section	Stainless steel	AISI304 or AISI316
6	Impeller	Stainless steel	AISI304 or AISI316
7	Shaft	Stainless steel	AISI304 or AISI316
8	Mechanical seal	BABE, BABV, BQQE, BQQV	
10	Base frame	Cast iron	
11	Front cover	Aluminum alloy	
12	Plug	Stainless steel	AISI304 or AISI316
CM			
1	Inlet section	Stainless steel	AISI304 or AISI316
9	Outlet section	Stainless steel	AISI304 or AISI316
CMH			
1	Inlet section	cast iron	
9	Outlet section	cast iron	

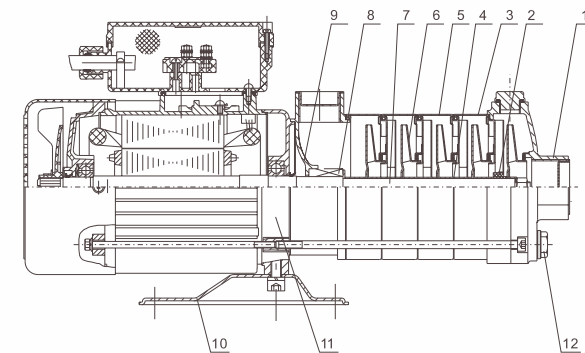



reserves the rights to modify design and technical specifications

Performance curve

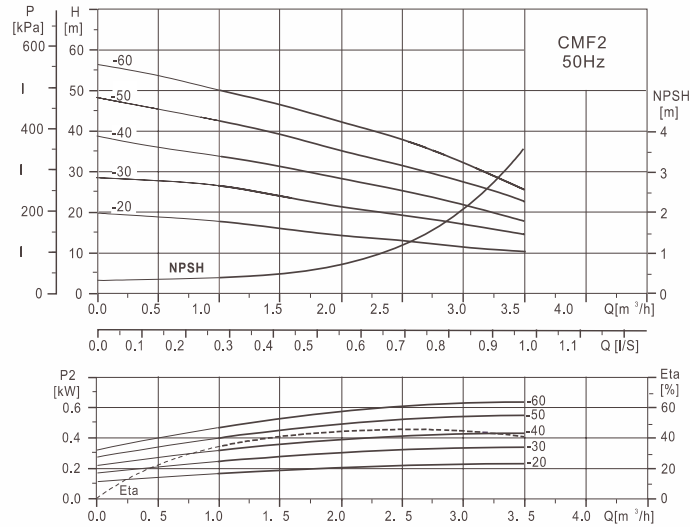

Performance table

Model		Driving motor P ₂ (KW)	Q (m ³ /h)	H (m)					
Single Phase	Three Phase			1.0	1.5	2.0	2.5	3.0	3.5
CMF2-20	CMF2-20T	0.37	18	16	14	13	11	10	
CMF2-30	CMF2-30T			27	24	21	20	17	14
CMF2-40	CMF2-40T	0.55	35	32	28	26	23	17	
CMF2-50	CMF2-50T	0.55	43	40	35	33	28	22	
CMF2-60	CMF2-60T	0.75	50	48	42	38	32	25	

Installation sketch

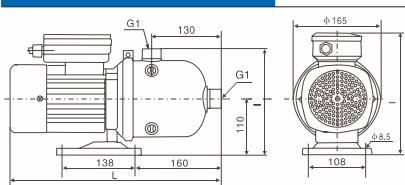

Model	Size(mm)				Weight (kg)
	Single Phase		Three Phase		
	L	H	L	H	
CMF2-20(T)	400	230	400	210	9
CMF2-30(T)	400	230	400	210	9.5
CMF2-40(T)	400	230	400	210	10
CMF2-50(T)	400	230	400	210	10
CMF2-60(T)	400	230	400	210	10.5

Performance curve

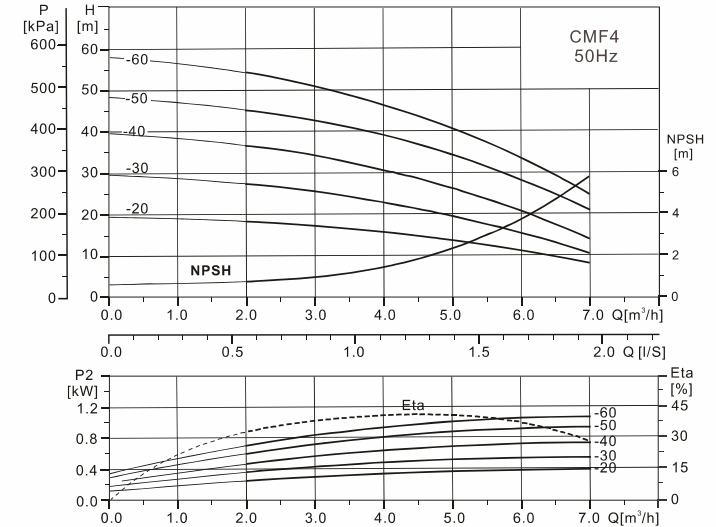

Performance table

Model		Driving motor P ₂ (KW)	Q (m ³ /h)	H (m)					
Single Phase	Three Phase			2.0	3.0	4.0	5.0	6.0	7.0
CMF4-20	CMF4-20T	0.55	18	16	15	13	10	7	
CMF4-30	CMF4-30T			27	25	22	19	15	10
CMF4-40	CMF4-40T	0.75	36	33	30	26	20	14	
CMF4-50	CMF4-50T	1.0	44	41	38	32	26	20	
CMF4-60	CMF4-60T	1.1	53	50	45	40	33	24	

Installation sketch

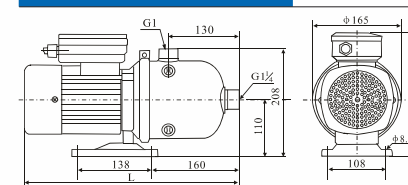

Model	Size(mm)				Weight (kg)
	Single Phase		Three Phase		
	L	H	L	H	
CMF4-20(T)	400	230	400	210	10
CMF4-30(T)	400	230	400	210	11
CMF4-40(T)	400	230	400	210	11.5
CMF4-50(T)	400	230	400	210	12
CMF4-60(T)	400	230	400	210	12.5



reserves the rights to modify design and technical specifications

Performance curve

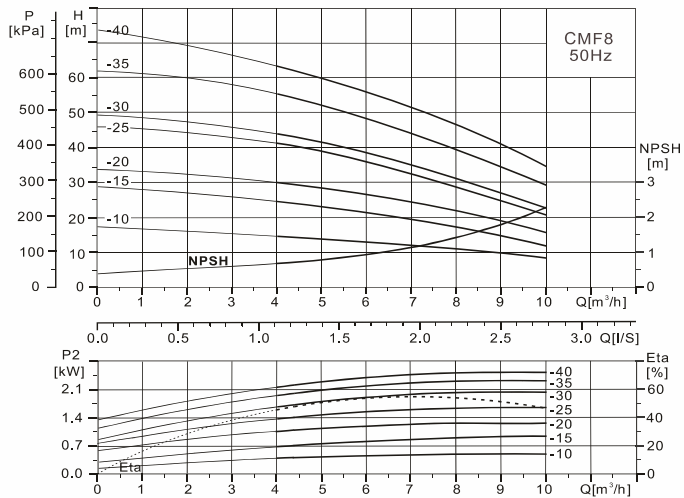

Performance table

Model		Driving motor P ₂ (KW)	Q (m³/h)	H (m)						
Single Phase	Three Phase			4.0	5.0	6.0	7.0	8.0	9.0	10
CMF8-10	CMF8-10T	0.55		15	14	13	12	10	9	8
CMF8-15	CMF8-15T	0.75		25	23	22	20	17	14	12
CMF8-20	CMF8-20T	1.0		30	28	26	24	20	18	16
CMF8-25	CMF8-25T	1.5		43	37	34	30	27	24	20
CMF8-30	CMF8-30T	1.85		44	42	38	36	30	27	24
CMF8-35	CMF8-35T	2.2		56	51	48	44	37	32	28
CMF8-40	CMF8-40T	2.2		65	57.5	57	50	45	40	34

Installation sketch

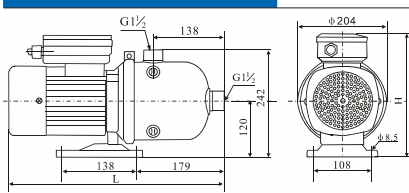

Model	Size(mm)				Weight (kg)
	Single Phase		Three Phase		
	L	H	L	H	
CMF8-10(T)	420	250	420	210	10.5
CMF8-15(T)	420	250	420	210	12.0
CMF8-20(T)	420	250	420	210	14.0
CMF8-25(T)	450	250	450	235	17.0
CMF8-30(T)	510	261	450	235	21.5
CMF8-35(T)	510	261	450	235	23
CMF8-40(T)	510	261	450	235	24

pump cover with G2 inlet/outlet is available

Performance curve

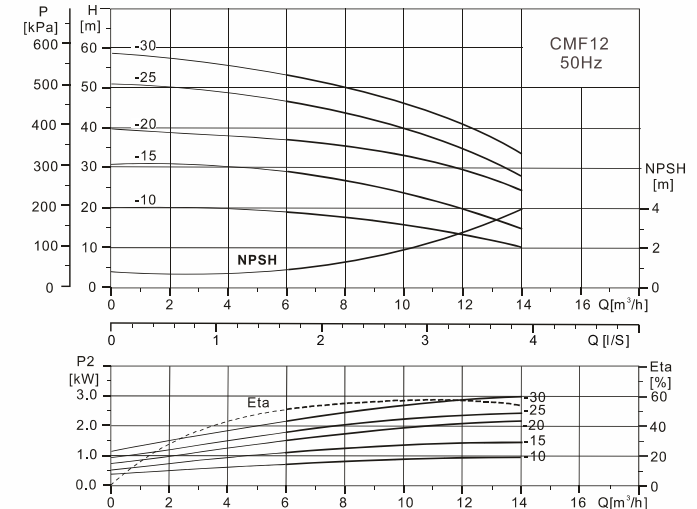

Performance table

Model		Driving motor P ₂ (KW)	Q (m³/h)	H (m)									
Single Phase	Three Phase			6.0	7.0	8.0	9.0	10	11	12	13	14	
CMF12-10	CMF12-10T	1.0		19	18	17.5	16	15.5	14	13.5	12	10.5	
CMF12-15	CMF12-15T	1.5		28	27	26	25	24	22	20	18	15	
CMF12-20	CMF12-20T	1.85		38	36	35	32	31	29	28	24	20	
CMF12-25	CMF12-25T	2.2		47	45	43	41.5	39	36	33.5	30.5	27	
	CMF12-30T	3.0		53.5	52	50	47.5	45	42	39	35	30	

Installation sketch

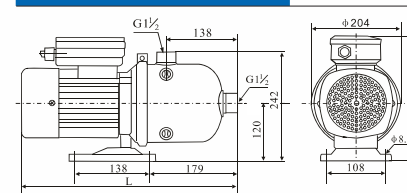

Model	Size(mm)				Weight (kg)
	Single Phase		Three Phase		
	L	H	L	H	
CMF12-10(T)	420	250	420	210	12.0
CMF12-15(T)	450	250	450	235	13.5
CMF12-20(T)	510	261	450	235	21.0
CMF12-25(T)	510	261	450	235	24.0
CMF12-30T	-	-	540	235	27

pump cover with G2 inlet/outlet is available



Performance curve

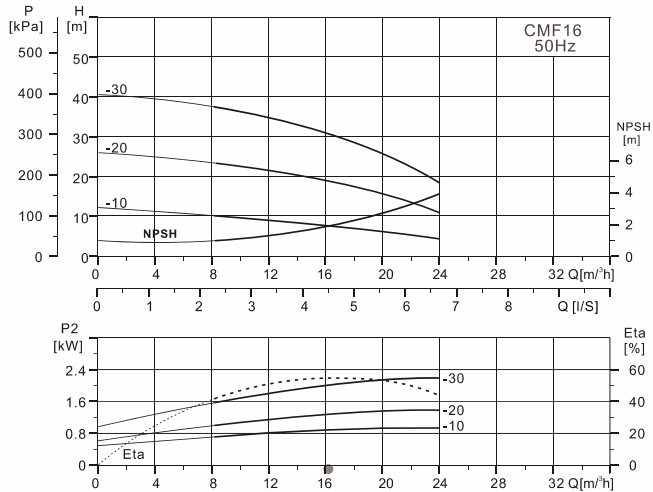

Performance table

Model		Driving motor P ₂ (KW)	Q (m ³ /h)	H (m)																			
Single Phase	Three Phase			8	10	12	14	16	18	20	22	24											
CMF16-10	CMF16-10T	1.0	H (m)	12	11.5	11	10.5	10	9	8	7	6											
CMF16-20	CMF16-20T	1.5		24	23	22	21	20	19	16	14	12											
CMF16-30	CMF16-30T	2.2		38	36	34	33	30	28	26	23	20											

Installation sketch

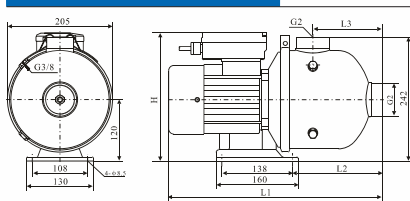

Model	Size(mm)								Weight (kg)
	Single Phase				Three Phase				
	L	L2	L3	H	L	L2	L3	H	
CMF16-10(T)	452	175	136	254	452	175	136	228	13.5
CMF16-20(T)	452	175	136	254	452	175	136	228	17
CMF 16-30(T)	520	201	162	261	520	201	162	235	23

Performance curve

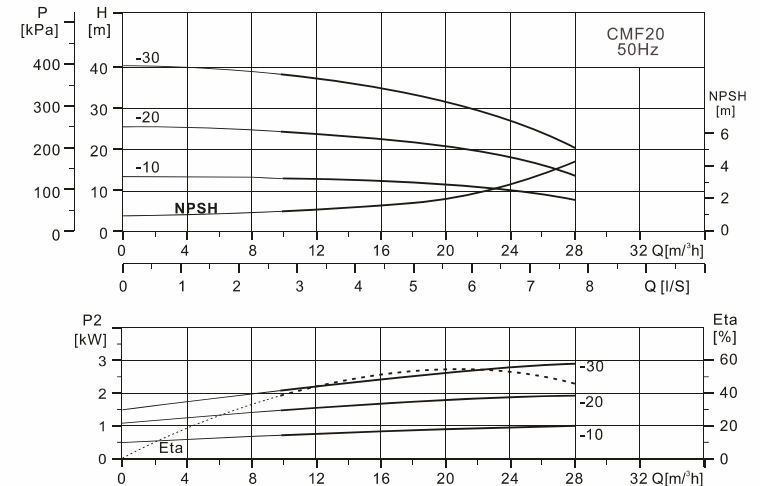

Performance table

Model		Driving motor P ₂ (KW)	Q (m ³ /h)	H (m)																			
Single Phase	Three Phase			10	12	14	16	18	20	22	24	26	28										
CMF20-10	CMF20-10T	1.0	H (m)	13	12.5	12	11.5	11	10.5	10	9	8.5	7.5										
CMF20-20	CMF20-20T	1.85		25	24	23	22	21	20	18	16	14	12										
	CMF20-30T	3.0		39	38	36	35	33	31.5	30	27	24	21										

Installation sketch

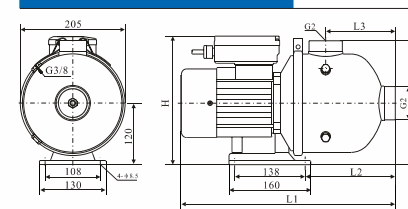

Model	Size(mm)								Weight (kg)
	Single Phase				Three Phase				
	L	L2	L3	H	L	L2	L3	H	
CMF20-10(T)	420	175	136	244	420	175	136	218	20
CMF20-20(T)	494	175	136	261	452	175	136	228	22
CMF20-30T	-	-	-	-	520	201	162	235	25



reserves the rights to modify design and technical specifications

Performance curve

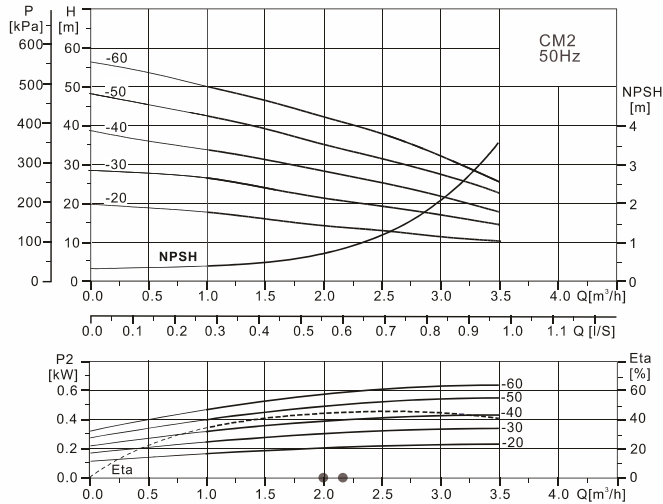

Performance table

Model		Driving motor P ₂ (KW)	Q (m ³ /h)	H (m)						
Single Phase	Three Phase			1.0	1.5	2.0	2.5	3.0	3.5	
CM2-20	CM2-20T	0.37	H (m)	18	16	14	13	11	10	
CM2-30	CM2-30T			27	24	21	20	17	14	
CM2-40	CM2-40T			35	32	28	26	23	17	
CM2-50	CM2-50T			43	40	35	33	28	22	
CM2-60	CM2-60T			50	48	42	38	32	25	

Installation sketch

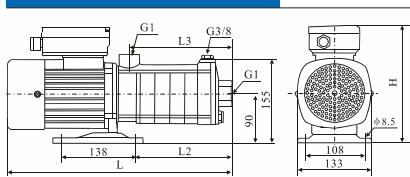

Model	Size(mm)								Weight (kg)
	Single Phase				Three Phase				
	L	L2	L3	H	L	L2	L3	H	
CM2-20(T)	326	90	100	210	326	90	100	190	8.5
CM2-30(T)	344	108	118	210	344	108	118	190	9
CM2-40(T)	362	126	136	210	362	126	136	190	9.5
CM2-50(T)	380	144	154	210	380	144	154	190	9.5
CM2-60(T)	398	162	172	210	398	162	172	190	10.5

Performance curve

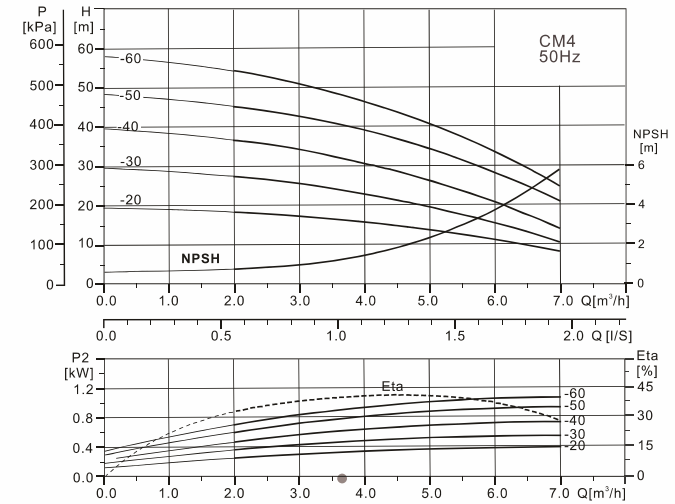

Performance table

Model		Driving motor P ₂ (KW)	Q (m ³ /h)	H (m)						
Single Phase	Three Phase			2.0	3.0	4.0	5.0	6.0	7.0	
CM4-20	CM4-20T	0.55	H (m)	18	16	15	13	10	7	
CM4-30	CM4-30T			27	25	22	19	15	10	
CM4-40	CM4-40T			36	33	30	26	20	14	
CM4-50	CM4-50T			44	41	38	32	26	20	
CM4-60	CM4-60T			53	50	45	40	33	24	

Installation sketch

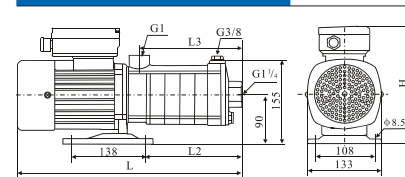

Model	Size(mm)								Weight (kg)
	Single Phase				Three Phase				
	L	L2	L3	H	L	L2	L3	H	
CM4-20(T)	335	99	109	210	335	99	109	190	9
CM4-30(T)	362	126	136	210	362	126	136	190	10
CM4-40(T)	389	153	163	210	389	153	163	190	10.5
CM4-50(T)	416	180	190	210	416	180	190	190	11
CM4-60(T)	443	207	217	210	443	207	217	190	12



Performance curve

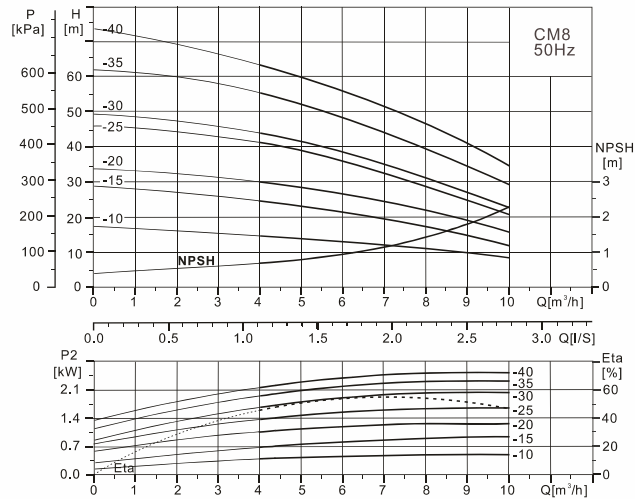

Performance table

Model		Driving motor P ₂ (kW)	Q (m³/h)	H (m)														
Single Phase	Three Phase			4.0	5.0	6.0	7.0	8.0	9.0	10	11	12	13	14				
CM8-10	CM8-10T	0.55	H (m)	15	14	13	12	10	9	8								
CM8-15	CM8-15T	0.75		25	23	22	20	17	14	12								
CM8-20	CM8-20T	1.0		30	28	26	24	20	18	16								
CM8-25	CM8-25T	1.5		43	37	34	30	27	24	20								
CM8-30	CM8-30T	1.85		44	42	38	36	30	27	24								
CM8-35	CM8-35T	2.2		56	51	48	44	37	32	28								
CM8-40	CM8-40T	2.2		65	57.5	57	50	45	40	34								

Installation sketch

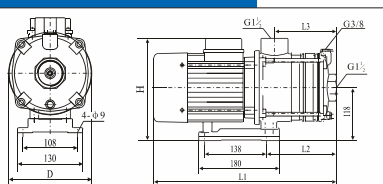

Model	Size(mm)										Weight (kg)
	Single Phase					Three Phase					
	L1	L2	L3	H	D	L1	L2	L3	H	D	
CM8-10(T)	316	96	78	244	165	316	96	78	218	165	12
CM8-15(T)	346	126	108	244	165	346	126	108	218	165	14
CM8-20(T)	346	126	108	244	165	346	126	108	218	165	17
CM8-25(T)	412	156	138	254	165	412	156	138	228	165	19
CM8-30(T)	450	156	138	261	176	412	156	138	228	165	24
CM8-35(T)	480	186	168	261	176	442	186	168	228	165	25
CM8-40(T)	480	186	168	261	176	442	186	168	228	165	26

pump cover with G2 inlet/outlet is available

Performance curve

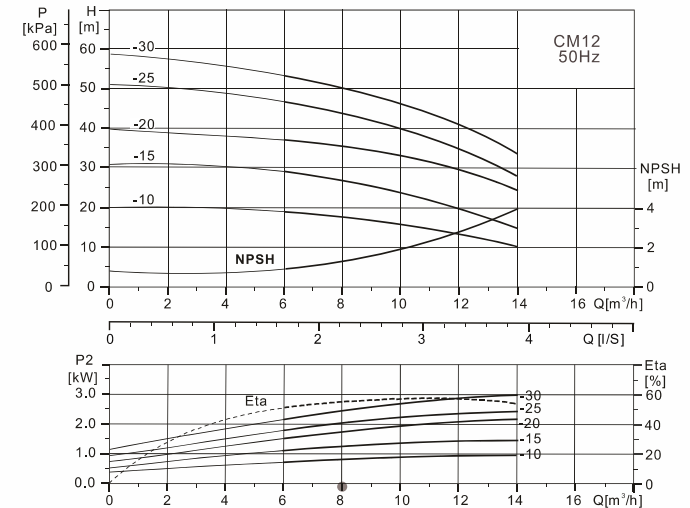

Performance table

Model		Driving motor P ₂ (kW)	Q (m³/h)	H (m)													
Single Phase	Three Phase			6.0	7.0	8.0	9.0	10	11	12	13	14					
CM12-10	CM12-10T	1.0	H (m)	19	18	17.5	16	15.5	14	13.5	12	10.5					
CM12-15	CM12-15T	1.5		28	27	26	25	24	22	20	18	15					
CM12-20	CM12-20T	1.85		38	36	35	32	31	29	28	24	20					
CM12-25	CM12-25T	2.2		47	45	43	41.5	39	36	33.5	30.5	27					
	CM12-30T	3.0		53.5	52	50	47.5	45	42	39	35	30					

Installation sketch

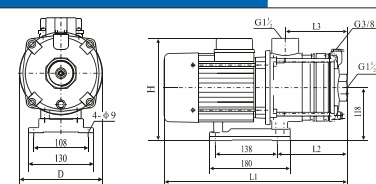

Model	Size(mm)										Weight (kg)
	Single Phase					Three Phase					
	L1	L2	L3	H	D	L1	L2	L3	H	D	
CM12-10(T)	316	96	78	244	165	316	96	78	218	165	13
CM12-15(T)	412	126	108	254	165	412	126	108	228	165	15
CM12-20(T)	420	126	108	261	176	412	126	108	228	165	23
CM12-25(T)	420	156	138	261	176	412	156	138	228	165	25
CM12-30T	-	-	-	-	468	156	138	235	176	27	

pump cover with G2 inlet/outlet is available



Performance curve

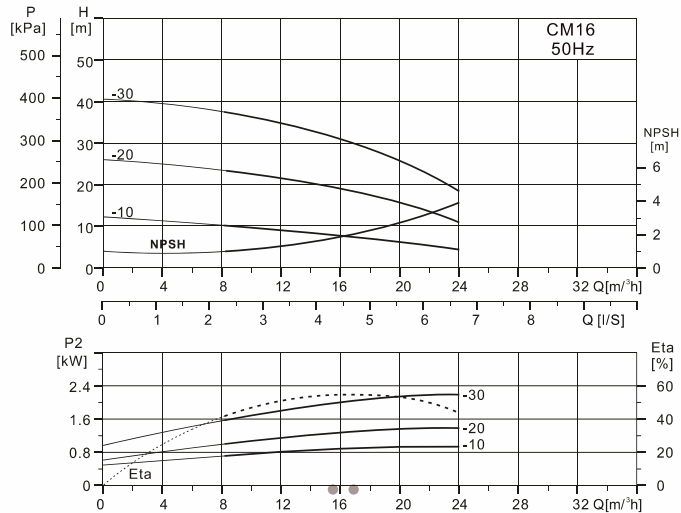

Performance table

Model		Driving motor P ₂ (kW)	Q (m³/h)	H (m)											
Single Phase	Three Phase			8	10	12	14	16	18	20	22	24			
CM16-10	CM16-10T	1.0	H (m)	12	11.5	11	10.5	10	9	8	7	6			
CM 16-20	CM16-20T	1.5		24	23	22	21	20	19	16	14	12			
CM16-30	CM16-30T	2.2		38	36	34	33	30	28	26	23	20			
	CM16-40T	3.0		50	48	46	44	40	38	36	32	28			

Installation sketch

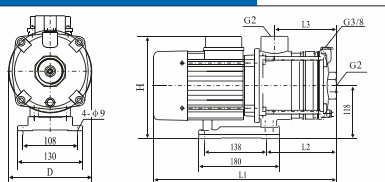

Model	Size(mm)										Weight (kg)
	Single Phase					Three Phase					
	L1	L2	L3	H	D	L1	L2	L3	H	D	
CM16-10(T)	326	106	81	244	165	326	106	81	218	165	12
CM16-20(T)	406	151	126	254	165	406	151	126	228	165	18
CM16-30(T)	489	196	171	254	176	489	196	171	235	176	25
CM16-40T	552	241	216	261	176	534	241	216	235	176	28

Performance curve

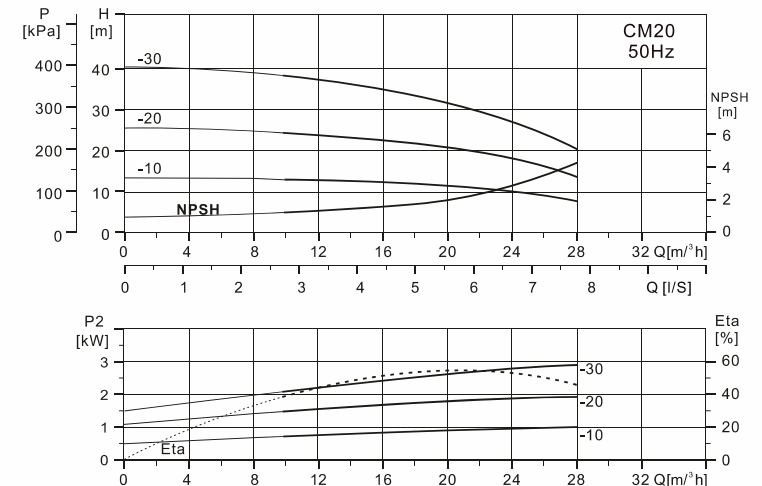

Performance table

Model		Driving motor P ₂ (kW)	Q (m³/h)	H (m)										
Single Phase	Three Phase			10	12	14	16	18	20	22	24	26	28	
CM20-10	CM20-10T	1.0	H (m)	13	12.5	12	11.5	11	10.5	10	9	8.5	7.5	
CM20-20	CM20-20T	1.85		25	24	23	22	21	20	18	16	14	12	
	CM20-30T	3.0		39	38	36	35	33	31.5	30	27	24	21	

Installation sketch

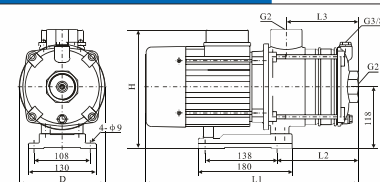

Model	Size(mm)										Weight (kg)
	Single Phase					Three Phase					
	L1	L2	L3	H	D	L1	L2	L3	H	D	
CM20-10(T)	376	106	81	254	165	376	106	81	228	165	14
CM20-20(T)	444	151	126	261	176	406	151	126	228	165	24
CM20-30T	-	-	-	-	-	507	196	171	235	176	28



Performance curve

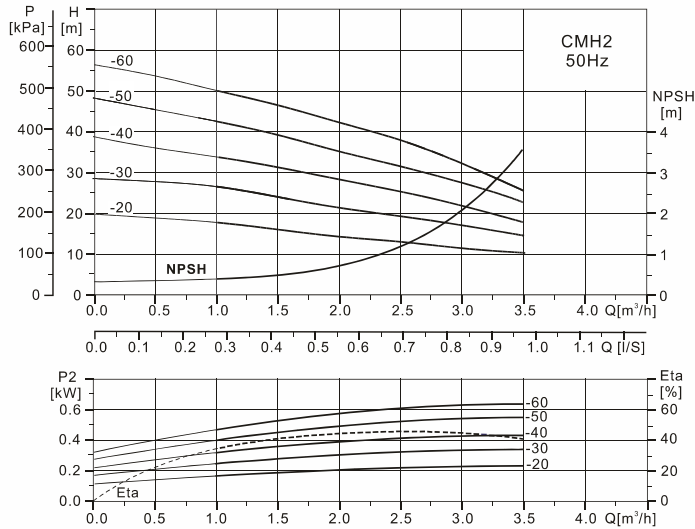

Performance table

Model		Driving motor P ₂ (KW)	Q (m ³ /h)	H (m)					
Single Phase	Three Phase			1.0	1.5	2.0	2.5	3.0	3.5
CMH2-20	CMH2-20T	0.37	18	16	14	13	11	10	
CMH2-30	CMH2-30T			27	24	21	20	17	14
CMH2-40	CMH2-40T	0.55	35	32	28	26	23	17	
CMH2-50	CMH2-50T	0.55	43	40	35	33	28	22	
CMH2-60	CMH2-60T	0.75	50	48	42	38	32	25	

Installation sketch

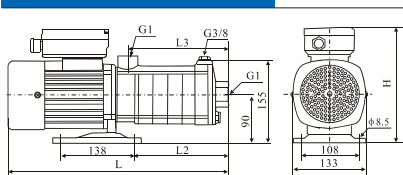

Model	Size(mm)								Weight (kg)
	Single Phase				Three Phase				
	L1	L2	L3	H	L1	L2	L3	H	
CMH2-20(T)	326	90	100	210	326	90	100	190	8.5
CMH2-30(T)	344	108	118	210	344	108	118	190	9
CMH2-40(T)	362	126	136	210	362	126	136	190	9.5
CMH2-50(T)	380	144	154	210	380	144	154	190	10
CMH2-60(T)	398	162	172	210	398	162	172	190	10.5

Performance curve

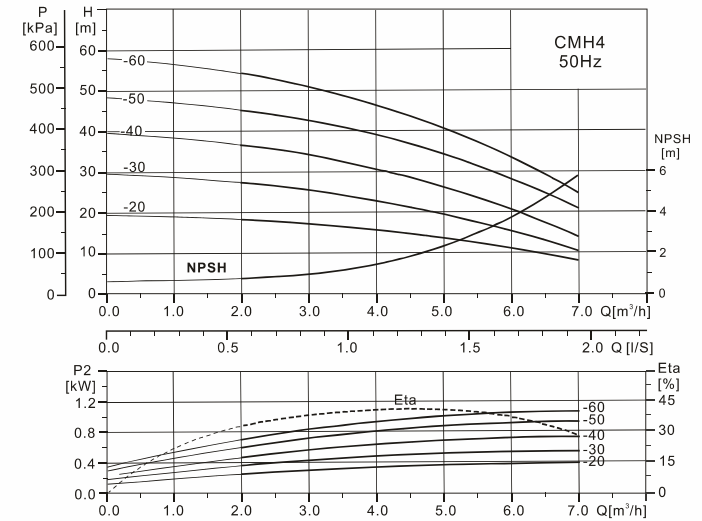

Performance table

Model		Driving motor P ₂ (KW)	Q (m ³ /h)	H (m)					
Single Phase	Three Phase			2.0	3.0	4.0	5.0	6.0	7.0
CMH4-20	CMH4-20T	0.55	18	16	15	13	10	7	
CMH4-30	CMH4-30T			27	25	22	19	15	10
CMH4-40	CMH4-40T	0.75	36	33	30	26	20	14	
CMH4-50	CMH4-50T	1.0	44	41	38	32	26	20	
CMH4-60	CMH4-60T	1.1	53	50	45	40	33	24	

Installation sketch

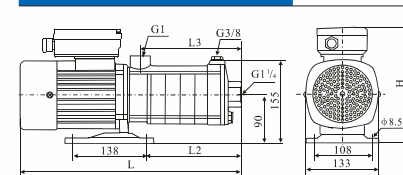

Model	Size(mm)								Weight (kg)
	Single Phase				Three Phase				
	L1	L2	L3	H	L1	L2	L3	H	
CMH4-20(I)	335	99	109	210	335	99	109	190	9
CMH4-30(T)	362	126	136	210	362	126	136	190	10
CMH4-40(T)	389	153	163	210	389	153	163	190	10.5
CMH4-50(T)	416	180	190	210	416	180	190	190	11
CMH4-60(T)	443	207	217	210	443	207	217	190	12



Performance curve

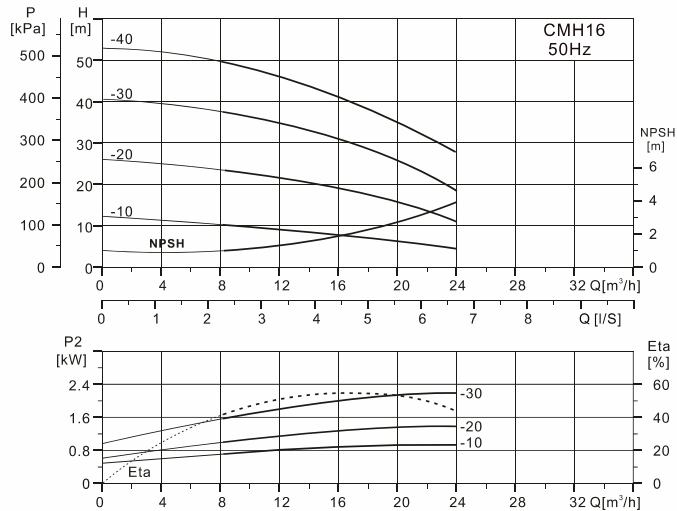

Performance table

Model		Driving motor P ₂ (KW)	Q (m ³ /h)	H (m)										
Single Phase	Three Phase			8	10	12	14	16	18	20	22	24		
CMH16-10	CMH16-10T	1.0	H (m)	12	11.5	11	10.5	10	9	8	7	6		
CMH16-20	CMH16-20T	1.5		24	23	22	21	20	19	16	14	12		
CMH16-30	CMH16-30T	2.2		38	36	34	33	30	28	26	23	20		
	CMH16-40T	3.0		50	48	46	44	40	38	36	32	28		

Installation sketch

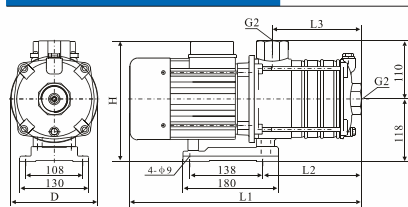

Model	Size(mm)										Weight (kg)
	Single Phase					Three Phase					
	L1	L2	L3	H	D	L1	L2	L3	H	D	
CMH16-10(T)	325	106	81	254	165	325	106	81	218	165	14
CMH16-20(T)	406	151	126	254	165	406	151	126	228	165	20
CMH16-30(T)	493	196	171	235	176	493	196	171	235	176	27
CMH16-40T	-	-	-	-	555	241	216	235	176	30	

Performance curve

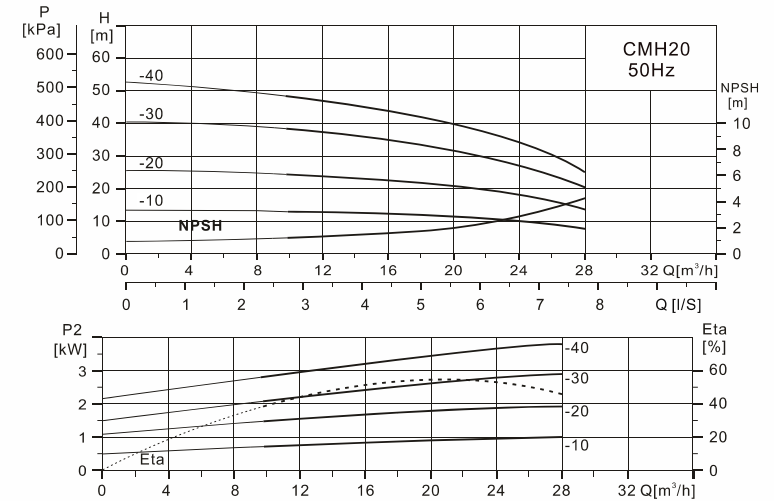

Performance table

Model		Driving motor P ₂ (KW)	Q (m ³ /h)	H (m)										
Single Phase	Three Phase			10	12	14	16	18	20	22	24	26	28	
CMH20-10	CMH20-10T	1.0	H (m)	13	12.5	12	11.5	11	10.5	10	9	8.5	7.5	
CMH20-20	CMH20-20T	1.85		25	24	23	22	21	20	18	16	14	12	
	CMH20-30T	3.0		39	38	36	35	33	31.5	30	27	24	21	
	CMH20-40T	4.0		50	48	46	44	42	40	36	32	28	24	

Installation sketch

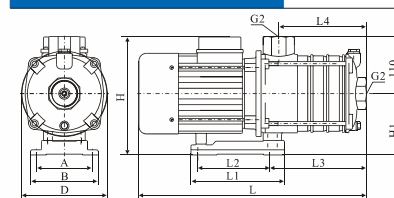

Model	Size(mm)										Weight (kg)
	A	B	D	L	L1	L2	L3	L4	H	H1	
CMH20-10	108	130	165	325	180	138	106	81	244	118	16
CMH20-20	108	130	176	450	180	138	151	126	235	118	26
CMH20-10T	108	130	165	325	180	138	106	81	218	118	15.5
CMH20-20T	108	130	165	406	180	138	151	126	228	118	25.5
CMH20-30T	108	130	176	510	180	138	196	171	235	118	30
CMH20-40T	160	200	195	575	176	140	316	216	248	100	35